



Body Size

1/4"

1000 bar

# HP1000-Series



## Technical Description

The Tema high pressure coupling was specially developed for use in industrial machinery, salvage devices and testing equipment. This series is galvanised and produced in steel. The plug part and the sleeve are hardened and galvanised in steel. The coupling can be supplied either with or without additional safety lock.

## Advantages

High flow as a result of optimised valve design. Additional plug sealing via polymer valve casing, to guarantee high reliability seals even with second-hand plugs. Tema high pressure couplings are supplied with dust caps inclusive!

## Seals

Coupling: bonded seal washer  
Plug: bonded seal or innercone

## Working Pressure

1000 bar

## Working Temperature

-30°C up to +100°C (NBR) depending on the medium. Special seals are available on request (see page 6 ff).

## Available Valves



## Applications Area



Material Coupling	Standard
Coupling Body	Steel, zinc plated, passivated, sealed
Sleeve	Steel, hardened, zinc plated, passivated, sealed
Valve	Steel, zinc plated, passivated, sealed
Springs	AISI 302
Locking Balls	AISI 420 C
Seals	NBR
Inner Sleeve	POM
Plug	Standard
Plug Body	Steel, hardened, zinc plated, passivated, sealed
Valve	Steel, zinc plated, passivated, sealed
Springs	AISI 302
Seals	NBR
Valve Retainer	Steel, zinc plated, passivated

## Flow Capacity with Oil with Viscosity of 32cSt at 40°C as per ISO 7241/2-2000

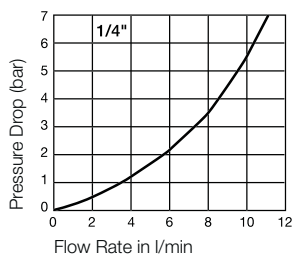

## Couplings

## HP1000-Series

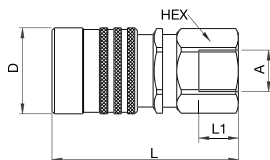

Female Thread

Conne- tion A	Hex mm	L mm	L1 mm	D mm	Safety Locking	Work. Pressure connect. in bar	Work. Pressure disconnect. in bar	Burst. Pressure connect.in bar	Part Number
G 1/4	24	59	12	27	without	1000	1000	>3000	HP10104131
G 1/4	24	59	12	27	with	1000	1000	>3000	HP10104132
1/4"-18 NPTF	24	59	12	27	without	1000	1000	>3000	HP10105131
1/4"-18 NPTF	24	59	12	27	with	1000	1000	>3000	HP10105132
G 3/8	24	59	12	27	without	1000	1000	>3000	HP10104171
G 3/8	24	59	12	27	with	1000	1000	>3000	HP10104172
3/8"-18 NPTF	24	59	13	27	without	1000	1000	>3000	HP10105171
3/8"-18 NPTF	24	59	13	27	with	1000	1000	>3000	HP10105172

## Plugs

## HP1000-Series

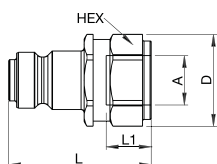

Female Thread

Conne- tion A	Hex mm	L mm	L1 mm	D mm	Safety Locking	Work. Pressure connect. in bar	Work. Pressure disconnect. in bar	Burst. Pressure connect.in bar	Part Number
G 1/4	22	37	12	24,5		1000	1000	>3000	HP1020413
1/4"-18 NPTF	22	37	12	24,5		1000	1000	>3000	HP1020513
G 3/8	24	37	12	24,5		1000	1000	>3000	HP1020417
3/8"-18 NPTF	24	37	13	24,5		1000	1000	>3000	HP1020517

## Dust Protection

## HP1000-Series

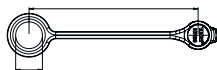
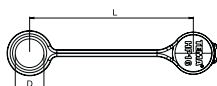

Version	L mm	D mm	Material	Color	Part Number
for coupling	120	21	PVC	Blue	HP16
for coupling	125		Aluminium	Red	HP16ARD
for plug	120	19	PVC	Blue	HP26
for plug	140		Aluminium	Red	HP26ARD



Body Size

1/4"

1500 bar

# HP1500-Series



## Technical Description

The Tema high pressure coupling was specially developed for use in bolt tensioning equipment. This series is produced in steel. The plug bodies and the sleeves are black galvanised. The coupling can be supplied either with or without additional safety lock.

## Advantages

High flow as a result of optimised valve design. Additional plug sealing via polymer valve casing, to guarantee high reliability seals even with second-hand plugs. Tema high pressure couplings are supplied with dust caps inclusive!

## Seals

Metal sealing cone threaded adapters/metal sealing cone adapters.

## Working Pressure

1500 bar

## Working Temperature

-30°C up to +100°C (NBR) depending on the medium. Special seals are available on request (see page 6 ff).

## Available Valves



## Applications Area



Material Coupling	Standard
Coupling Body	Steel, zinc-nickel coated, black passivated, sealed
Sleeve	Steel, hardened, zinc-iron coated, black passivated, sealed
Valve	Steel, zinc plated, passivated, sealed
Springs	AISI 302
Locking Balls	AISI 420 C
Seals	NBR
Inner Sleeve	POM
Plug	Standard
Plug Body	Steel, hardened, zinc-iron coated, black passivated, sealed
Valve	Steel, zinc plated, passivated, sealed
Springs	AISI 302
Seals	NBR
Valve Retainer	Steel, zinc plated, passivated

## Flow Capacity with Oil with Viscosity of 32cSt at 40°C as per ISO 7241/2-2000

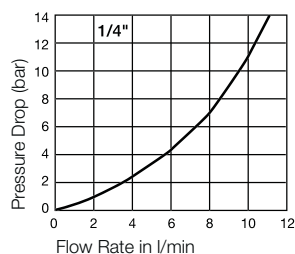

## Couplings

## HP1500-Series

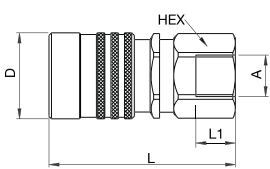
	Conne- ction A	Hex mm	L mm	L1 mm	D mm	Safety Locking	Work. Pressure connect. in bar	Work. Pressure disconnect. in bar	Burst. Pressure connect.in bar	Part Number
 <p>Female Thread</p>	G 1/4	24	59	12	27	without	1500	1500	>3500	HP15104131
	G 1/4	24	59	12	27	with	1500	1500	>3500	HP15104132
	1/4"-18 NPTF	24	59	12	27	without	1500	1500	>3500	HP15105131
	1/4"-18 NPTF	24	59	12	27	with	1500	1500	>3500	HP15105132
	G 3/8	24	59	12	27	without	1500	1500	>3500	HP15104171
	G 3/8	24	59	12	27	with	1500	1500	>3500	HP15104172
	3/8"-18 NPTF	24	59	13	27	without	1500	1500	>3500	HP15105171
	3/8"-18 NPTF	24	59	13	27	with	1500	1500	>3500	HP15105172

## Plugs

## HP1500-Series

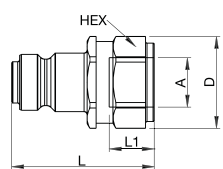
	Conne- ction A	Hex mm	L mm	L1 mm	D mm	Safety Locking	Work. Pressure connect. in bar	Work. Pressure disconnect. in bar	Burst. Pressure connect.in bar	Part Number
 <p>Female Thread</p>	G 1/4	22	38	12	24,5		1500	1500	>3500	HP1520413
	1/4"-18 NPTF	22	38	12	24,5		1500	1500	>3500	HP1520513

## Dust Protection

## HP1500-Series

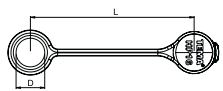
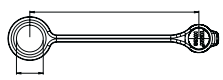
	Version	L mm	D mm	Material	Color	Part Number
	for coupling	120	21	PVC	Blue	HP16
	for coupling	125		Aluminium	Red	HP16ARD
	for plug	120	19	PVC	Blue	HP26
	for plug	140		Aluminium	Red	HP26ARD



Parker Tema中高压快速接头授权分销商联系方式：

信德迈科技(北京)有限公司 CNMEC Technology  
 北京朝阳区望京街10号望京SOHO-T1-C座2115室  
 邮编：100102  
 电话：010-8428 2935,8428 3983  
 手机：139 1096 2635  
 Http：//www.cnmec.biz  
 E-mail：sales@cnmec.biz  
 传真：010-8428 8762

⚠ Please consider our security advices on the pages 12/13 ⚠